

P. C. B Mounting Detail
Viewed From Mounting Side

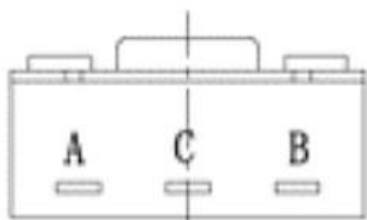

CW ROTATION

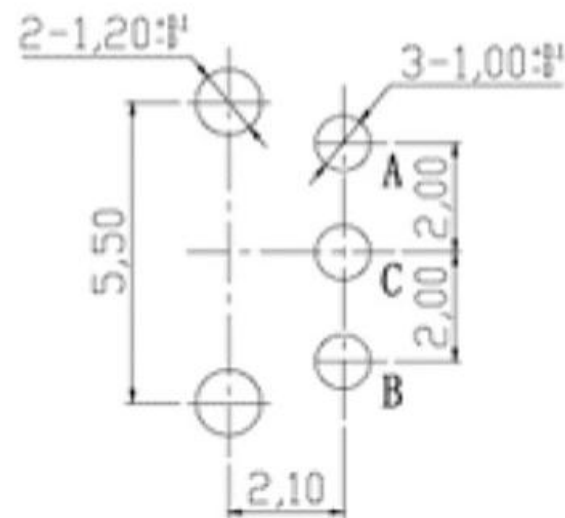
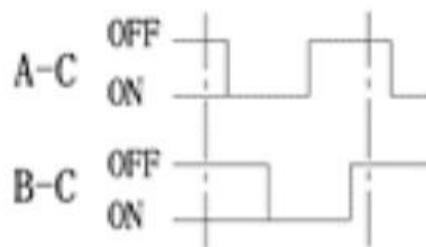

12 pulse 12 click

SPECIFICATIONS

- 1. Rating : DC 10V , 1 mA Max ;
- 2. Circuit : 1C - 1P ;
- 3. Operating force : 25 ±10 gf ;
- 4. Contact resistance : 100 mΩ Max ;
- 5. Travel : 0.25 ± 0.1 mm ;
- 6. Life : 150,000 Cycles Min .
(each upright and opposite roate)



东莞市高迪电子有限公司

Dong Guan KDRR Electronic Switch Jack Co., Ltd.

TOLERANCE UNLESS
OTHERWISE STATED :

Up to 5 ±0.2
Above 5 - 15 ±0.3
Above 15 - 30 ±0.4
Above 30 - 50 ±0.5
Angle ±0.3

3RD.
ANGEL'S



UNITS

MM

DRAWN BY:	DATE
Frank Wu	10/17/11
CHECKED BY:	DATE
Jacky Chen	10/17/11
APPROVED BY:	DATE
Tony Kao	10/17/11

MAT'L	TITLE	ENCODER
FINISH	MODLE	ENCODER
SCALE	1 : 1	DWG NO. K50-A
SHEET NO.	1 of 1	PART NO. K50-A
		SIZE A4
		VER A

ITEM NO	DESCRIPTION	DRAWN	DATE
---------	-------------	-------	------